

LEGEND

- CUT EARTHWORKS - CUT AREA WITHIN LOTS GREATER THAN 150mm DEPTH (FINISHED SURFACE OVER THE PRE-2012 BULK EARTHWORKS SURFACE)
- FILL EARTHWORKS - FILL AREA WITHIN LOTS GREATER THAN 150mm DEPTH (FINISHED SURFACE OVER THE PRE-2012 BULK EARTHWORKS SURFACE)
- B2 B2 TYPE KERB AS PER MPA FIG 008
- ES 150x150mm CONC. EDGE STRIP WITH SUBSOIL DRAINS UNDER.
- TEMPORARY TURNING AREA INCLUDING BOLLARDS.
- PROPOSED 200mm DEPTH (L 3 INOM.20mm) FCR PAVEMENT, BATTER TO SURFACE @ 1m6 AT EDGES & ACHIEVE FREE DRAINING SURFACE.
- TOP OF BATTER / RIDGE
- PROPOSED GAS & WATER/RECYCLED WATER CONDUITS REFER NOTE 7 ON SHEET 1
- PROPOSED ELECT. & TELECOMM. CONDUITS
- EXISTING SURFACE CONTOURS (0.25m INT.)
- BOLLARDS AS INDICATED.
- DIRECTION OF LOT FINISHED SURFACE FALL
- 3.0m S.U.P. 3.0m SHARED USER PATH. REFER TO MPA FIG.006 FOR DETAILS.
- CUT-OFF DRAIN AS PER DETAIL ON SHEET 10

WARNING

BEWARE OF UNDERGROUND SERVICES
THE LOCATIONS OF UNDERGROUND SERVICES ARE APPROXIMATE ONLY AND THEIR EXACT POSITION SHOULD BE PROVEN ON SITE. NO GUARANTEE IS GIVEN THAT ALL EXISTING SERVICES ARE SHOWN.

SCALE

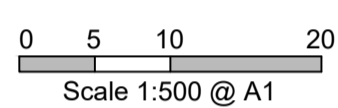

CONSTRUCTION PLAN

DISCLAIMER

THE CONTENT ON THIS PLAN IS FOR PRELIMINARY PURPOSES ONLY AND IS SUBJECT TO THE FORMAL PLANNING APPROVAL BY WYNDHAM CITY COUNCIL, DETAILED ENGINEERING DESIGN AND APPROVALS FROM WYNDHAM CITY COUNCIL AND ALL SERVICE AUTHORITIES. AS SUCH THIS PLAN IS SUBJECT TO CHANGE WITHOUT NOTICE. THIS PLAN IS NOT TO BE USED FOR ANY PURPOSE OTHER THAN FOR PRELIMINARY PURPOSES. HOUSE SITING SHOULD ONLY BE COMPLETED ONCE COUNCIL APPROVED PLANS ARE ISSUED. THE DEVELOPER BEARS NO RESPONSIBILITY FOR ANY OF THESE CHANGES. THE PURCHASER SHOULD ASCERTAIN THE DETAILS ARE CORRECT BEFORE PROCEEDING.

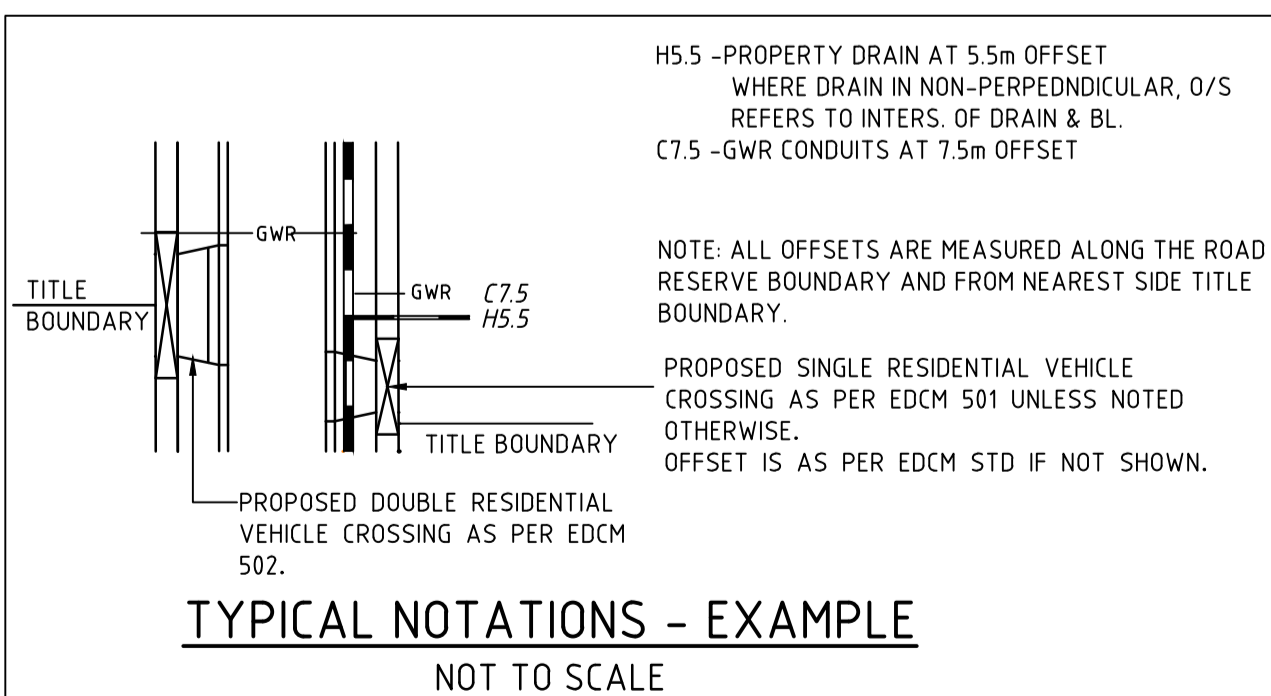
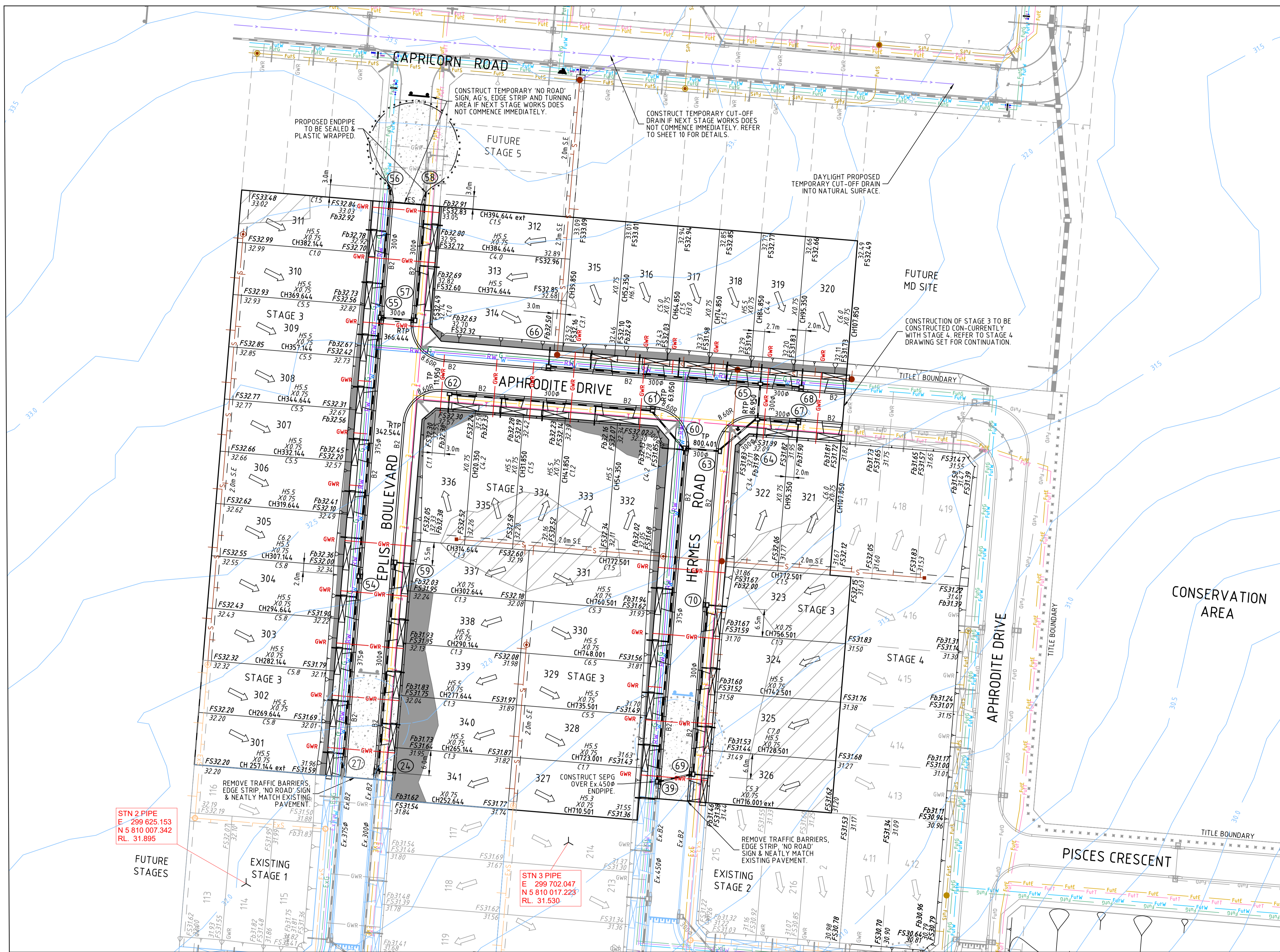

NOTES

- DESIGN LINE IS NOT IN CENTRE OF ROAD RESERVE. REFER TO CROSS SECTION FOR DETAILS.
- REFER TO SHEET 1 FOR MORE TBM DATA.
- THIS PLAN SHOWS ONLY APPROXIMATE EXTENTS & LEVELS OF FILL TO BE PLACED DURING CONSTRUCTION. DEPTH OF FILL USED FOR TOP DRESSING ALL ALLOTMENTS MAY VARY BY UP TO 0.15m. THE EXTENT OF FILL SHOWN IS BASED ON DESIGN AND MAY BE SUBJECT TO CHANGE FOLLOWING FINAL INSPECTION BY GEOTECHNICAL ENGINEER. EXISTING SURFACE LEVELS SHOWN REFER TO THOSE LEVELS EXISTING PRIOR TO LOT EARTHWORKS COMPLETED IN 2012.
- DRAINAGE CO-ORDINATES SHOWN REFER TO CENTRE OF PIT/PIPE.

SERVICE SCHEDULE

ROAD NAME	GAS O/S	Rec.WATER O/S	Dr.WATER O/S	ELECT. O/S	TELECOMM. O/S	SEWER O/S	BOK-T.B. DIST. U.N.O.	CARRIAGEWAY WIDTH (FOK-FOK)	ROAD RES. WIDTH	PATH WIDTH
APHRODITE DRIVE (LOTS 336 - 419)	2.25 N	2.70 N	3.20 N	2.60 S	1.775 S	100 N	4.35 N 4.05 S	7.30	16.00	1.50 BOTH
ELPIS BOULEVARD	2.25 W	2.70 W	3.20 W	2.60 E	1.775 E	NA	4.35 W 4.05 E	7.30	16.00	1.50 BOTH
HERMES ROAD	2.25 W	2.70 W	3.20 W	2.60 E	1.775 E	1.00E	4.35 W 4.05 E	7.30	16.00	1.50 BOTH

H:\22562\STAGE-3\CADD\DWG\SET\ROAD AND DRAINAGE\22562_3R2 & 7.DWG

THIS DRAWING IS NOT TO BE COPIED OR SCALED

VERSION	REMARKS	DATE	APP'D
F	LOT 327 HOUSE CONNECTION UPDATED	21.07.17	LP
D	LOT 309 & 314 PROPERTY CONNECTION	20.07.16	LP
E	ISSUED FOR CONSTRUCTION.	27.04.16	LP
C	CROSSOVER AMENDED AS PER EDM 501 & 502	17.02.16	LP
B	PIT 66 AND LOT 314 HOUSE DRAIN MOVED		LP

LEGEND

- GWR - GAS & WATER CONDUIT
- ES - EXISTING SURFACE
- H5.5 - PROPERTY DRAIN AT 5.5m OFFSET WHERE DRAIN IN NON-PERPENDICULAR, O/S REFERS TO INTERS. OF DRAIN & BL. C7.5 - GWR CONDUITS AT 7.5m OFFSET
- RECYCLED WATER
- EX RECYCLED WATER
- ELECTRICAL U.G. SERVICES
- EXISTING OR PROPOSED INVERT LEVEL OF PIPE
- EX ELECTRICAL U.G. SERVICES
- ELECTRICAL SERVICE & PIT
- EX ELECTRICAL ASSETS
- EX TELESTRAS OVERHEAD
- EASEMENT LINE
- TOP OF BATTER
- TOE OF BATTER
- FINISHED SURFACE AFTER CUTTING OR FILLING
- TOP OF PROPOSED BATTER
- PROPOSED PAVEMENT OR FOOTPATH SURFACE
- EXISTING OR PROPOSED INVERT LEVEL OF PIPE
- TANGENT POINT
- CH - CHAINAGE
- PSM - PAVEMENT SIGN
- STREET SIGN
- FENCE
- LOT FALL

DRAWN BY	I. VAKARAU	DESIGNED BY	L. PHAN
CHECKED BY	MELWAY	203 C2	R. HALFORD
AUTHORISED BY	DATUM	AHD	S. RAVIDA

REEDS CONSULTING

LAND SURVEYING
CIVIL ENGINEERING
PLANNING
DEVELOPMENT CONSULTING

www.reedsconsulting.com.au
engineering@reedsconsulting.com.au

Lvl 6, 440 Elizabeth Street Melbourne Victoria 3000
P 03 8660 3000

WYNDHAM CITY COUNCIL
80 WOODS ROAD, TRUGANINA
STAGES 3
LAYOUT PLAN

DRAWING No. **3R2** VERSION **F**

REFERENCE **22562E/3**

SHEET 2 OF 11