

ALCOCK ROAD CIVIL WORKS TO BE DESIGNED AND CONSTRUCTED BY DPM Pty Ltd EXCLUDING FOOTPATH AND VEHICLE CROSSINGS. CONSTRUCT FOOTPATH AND VEHICLE CROSSINGS ON ALCOCK ROAD AS SHOWN, MATCH TO EXISTING KERB LAYBACKS AND MAKE GOOD.

LOTS 1907 - 1910, 1922 - 1929, & 1932 BREAK IN AND CONNECT HOUSE DRAIN TO EXISTING DRAINAGE PIPE

NEATLY MATCH PAVEMENT, K&C & FOOTPATH INTO EXISTING AND MAKE GOOD

NEATLY MATCH FOOTPATH INTO EXISTING AND MAKE GOOD

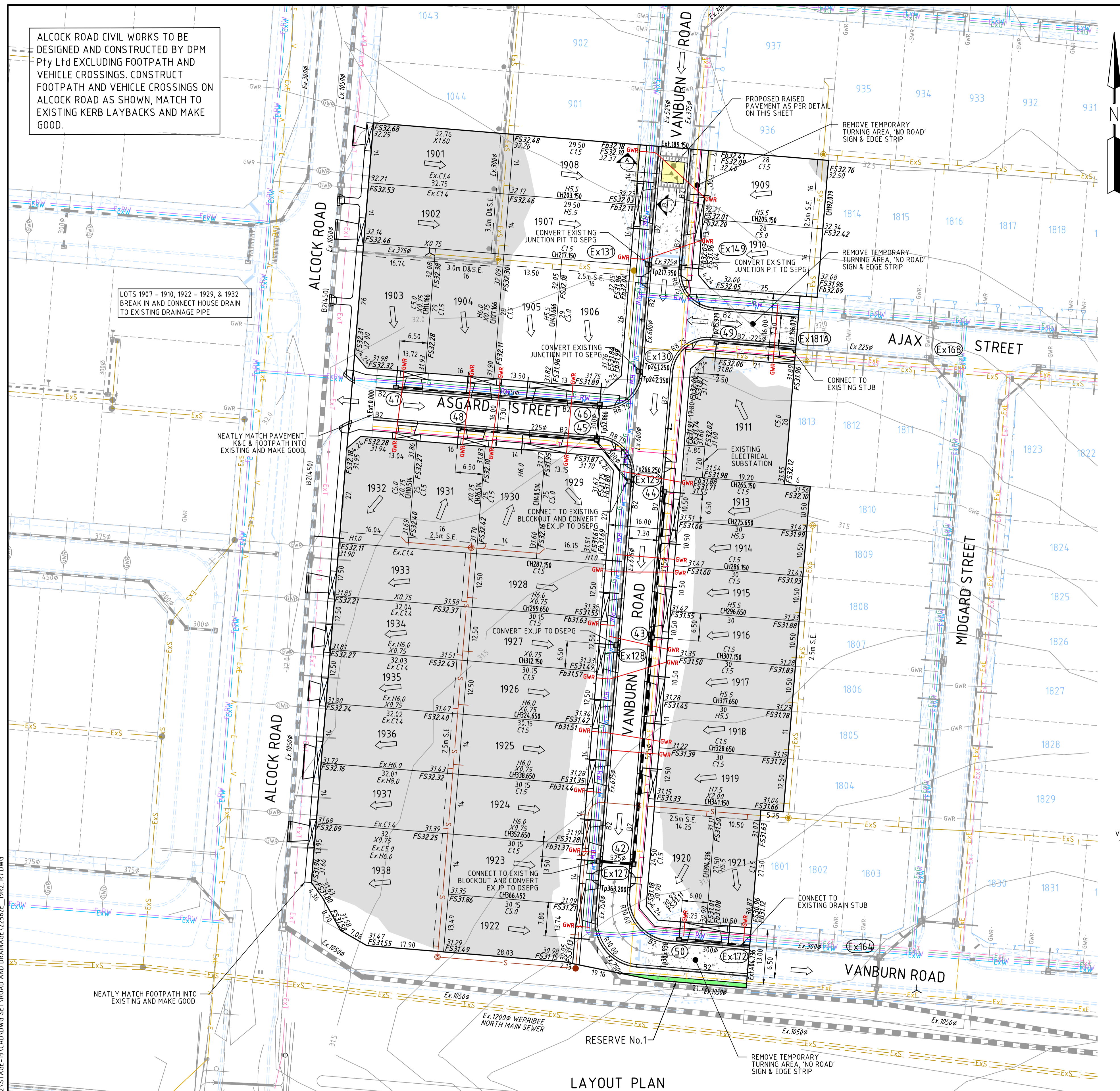

LEGEND

- FILL EARTHWORKS - FILL AREA WITHIN LOTS GREATER THAN 150mm DEPTH
- B2 600mm WIDE B2 TYPE BARRIER KERB & CHANNEL AS PER EDMC 301
- PROPOSED GAS & WATER/RECYCLED WATER CONDUITS } REFER NOTE 7 ON SHEET 1
- DIRECTION OF LOT FINISHED SURFACE FALL
- PROPOSED RAISED PAVEMENT (REFER DETAIL BELOW)
- RESERVE
- 31.50
 31.75
EXISTING SURFACE CONTOURS (0.25m INT.)

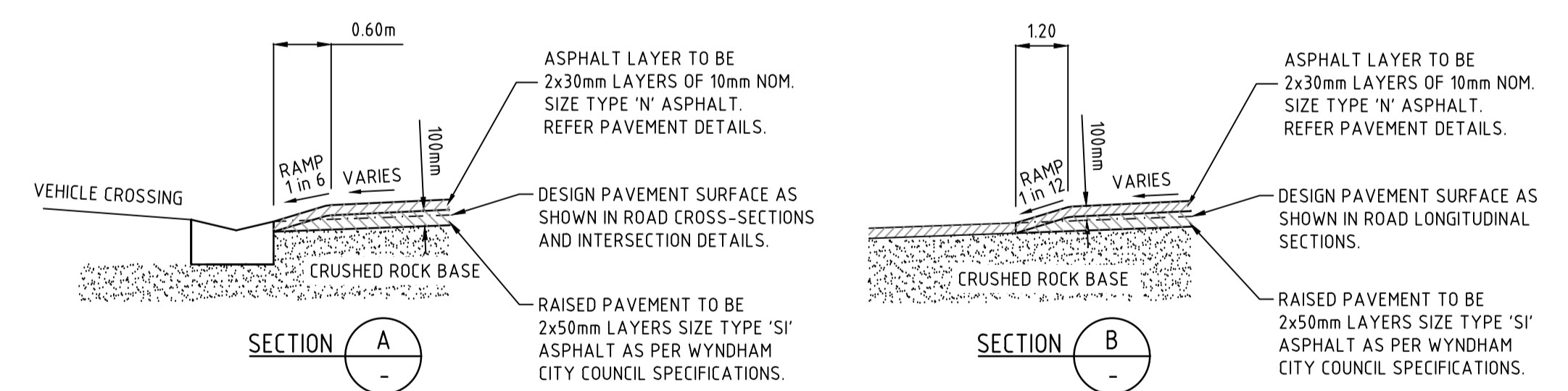
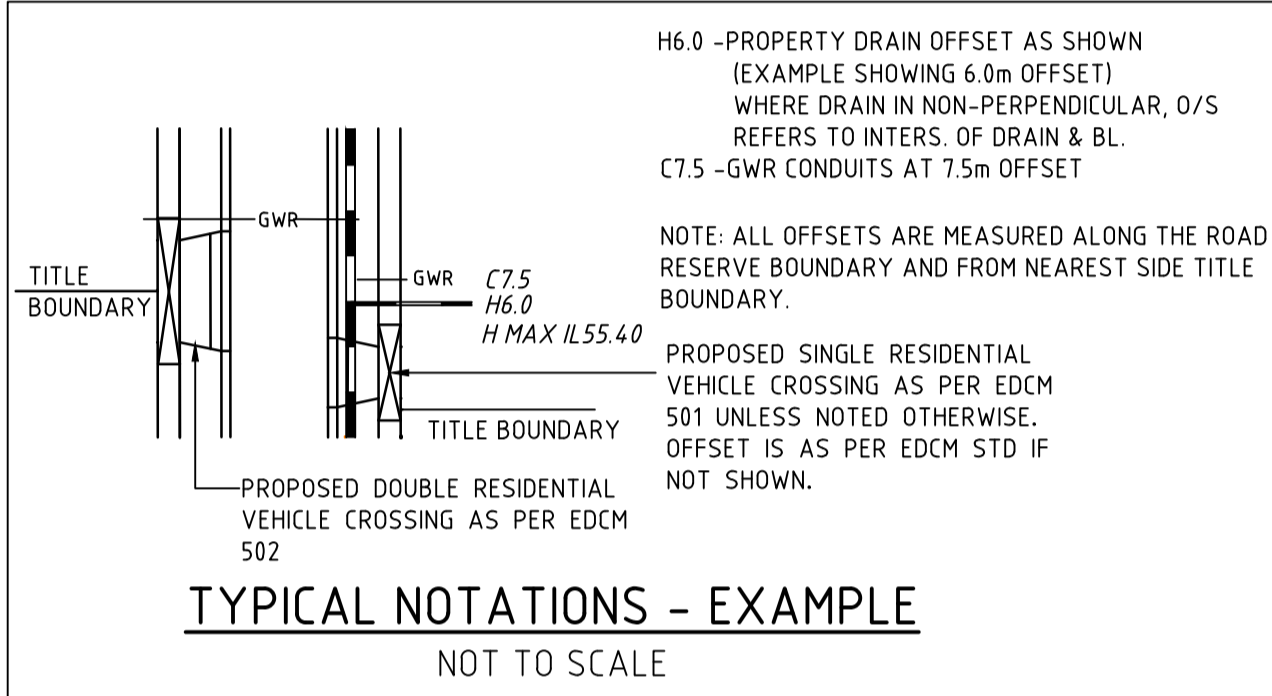

WARNING
BEWARE OF UNDERGROUND SERVICES
THE LOCATIONS OF UNDERGROUND SERVICES ARE APPROXIMATE ONLY AND THEIR EXACT POSITION SHOULD BE PROVEN ON SITE PRIOR TO COMMENCEMENT OF WORK. NO GUARANTEE IS GIVEN THAT ALL EXISTING SERVICES ARE SHOWN.

CONSTRUCTION PLAN

THIS DRAWING IS NOT TO BE COPIED OR SCALED

VERSION	REMARKS	DATE	BY
D	CONSTRUCTION ISSUE	07.11.19	JC
C	REMOVED PRAM CROSSING AT VANBURN RD/ASGARD ST	14.10.19	JC
B	COUNCIL COMMENTS (18.09.19)	26.09.19	JC
A	PRELIMINARY ISSUE	04.09.19	JC

LEGEND

	RAIN, PROPERTY INLET & PIT		RECYCLED WATER
	HOUSE DRAIN		ELECTRICAL U.G. SERVICES
	SEWER AND MAINTENANCE HOLE		GAS MAIN
	EX SEWER AND MAINTENANCE HOLE		ELECTRICAL SERVICE & PIT
	WATER MAIN		EX ELECTRICAL ASSETS
	EX WATER MAIN, VALVE & HYDRANT		EX ELECTRICAL OVERHEADS
	GAS MAIN		GAS & WATER CONDUITS
	EX GAS MAIN, VALVE		TOP OF BATTER
	TELSTRA SERVICES & PITS		TOP OF BATTER
	EX TELSTRA SERVICES & PITS		TOP OF BATTER

F	FINISHED SURFACE AFTER CUTTING OR FILLING	DRAWN BY	P.BRACOLIUS	DESIGNED BY	J.CHIN
Fb	TOP OF PROPOSED BATTER	CHECKED BY	J.CHIN	AUTHORISED BY	S.TSIALTAS
P	PROPOSED PAVEMENT OR FOOTPATH SURFACE	DATUM	AHD		
IL	EXISTING OR PROPOSED INVERT LEVEL OF PIPE				
OP	OR OPEN DRAIN				
TP	TANGENT POINT				
CH	CHAINAGE				
PSM	PROPOSED SIGN DRAINAGE PIT No.				
	EX FENCE				
	EX WALL OR BUILDING				

REEDS CONSULTING

www.reedsconsulting.com.au
engineering@reedsconsulting.com.au

Lvl 6, 440 Elizabeth Street Melbourne Victoria 3000
p (03) 8640 3000

LAND SURVEYING
CIVIL ENGINEERING
PLANNING
DEVELOPMENT CONSULTING

WYNDHAM CITY COUNCIL
ELPIS ESTATE, TRUGANINA - STAGE 19
(AS PART OF WYP8829/15.02 - STAGE 2)
LAYOUT PLAN

DRAWING No.	VERSION
19R2	D
REFERENCE	
22562E/19	
SHEET	2 OF 9