

ALCOCK ROAD CIVIL WORKS TO BE DESIGNED AND CONSTRUCTED BY DPM Pty Ltd. FINISHED FOOTPATH LEVELS FOR LOTS ABUTTING ALCOCK ROAD ARE TO BE CONFIRMED BY DPM Pty Ltd.

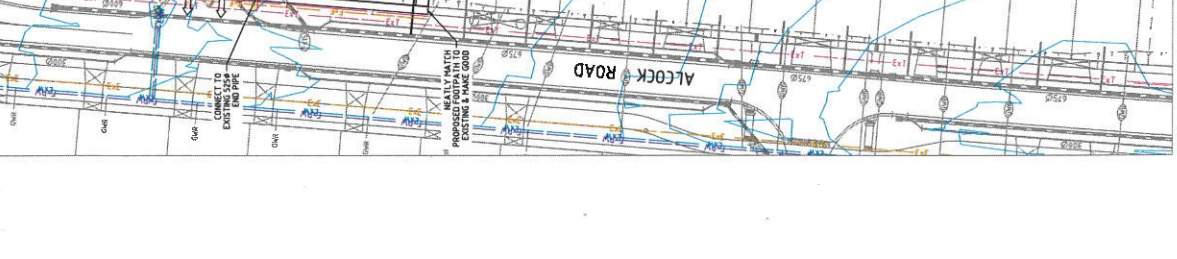

**Planning and Environment Act 1987**  
**Wyndham Planning Scheme**  
**Approved Plan As Required**  
**under Condition 25**  
**Permit No WYP9219/12**  
**Date 30/04/2020**

**LEGEND**

- PROPOSED GAS, DRINKING WATER & NON-DRINKING WATER CONDUITS
- OVERALL DIRECTION OF FLOW OF FAL ON LOTS AND OVERLAND FLOW PATH
- 300mm WIDTH SMT TYPE SPRING-MOUNTABLE KERB AS PER ECKO 392
- 400mm WIDTH OTY TYPE BARRIER KERB & CHANNEL AS PER ECKO 301
- CUT EARTHWORKS - CUT AREA WITHIN LOTS GREATER THAN 150mm DEPTH
- FILL EARTHWORKS - FILL AREA WITHIN LOTS GREATER THAN 150mm DEPTH
- TOP OF BATTER
- EXISTING SURFACE ELEVATIONS (1:2.5@ INT.)

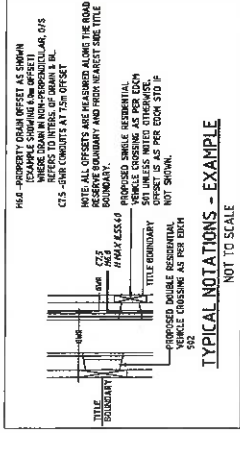

**WARNING**

BEWARE OF UNDERGROUND SERVICES  
THE LOCATIONS OF UNDERGROUND SERVICES ARE APPROXIMATE ONLY AND SHOULD BE VERIFIED BY THE CONSULTANT PRIOR TO COMMENCEMENT OF WORK. NO GUARANTEES GIVEN THAT ALL EXISTING SERVICES ARE SHOWN.

**CONSTRUCTION PLAN**  
Scale 1:300 @ A1

DRAWING No. **15R2** VERSION **E**  
REFERENCE **22562E/15** SHEET **2** OF **11**

WYNDHAM CITY COUNCIL  
80 WOODS ROAD, TRUGANINA  
STAGE 15  
LAYOUT PLAN

LAND SURVEYING CIVIL ENGINEERING PLANNING DEVELOPMENT CONSULTING

**REEDS**  
CONSULTING  
101/100 SOUTH STREET HOBART TAS 7000  
www.reedsengineering.com.au Ph: 03 6284 2888

REVISION	DATE	DRAWN BY	JOHN	DESIGNED BY	JOHN	ISSUED BY	STEFAN LARS
E	10/08/20	HELIANA	AND	CHECKED BY	JOHN	APPROVED BY	STEFAN LARS
D	08/07/20	HELIANA	AND	CHECKED BY	JOHN	APPROVED BY	STEFAN LARS
C	06/07/20	HELIANA	AND	CHECKED BY	JOHN	APPROVED BY	STEFAN LARS
B	04/07/20	HELIANA	AND	CHECKED BY	JOHN	APPROVED BY	STEFAN LARS
A	01/07/20	HELIANA	AND	CHECKED BY	JOHN	APPROVED BY	STEFAN LARS

THE DRAWING IS NOT TO BE COPIED OR SCALED

LEGEND

- EXISTING WATER
- NEW WATER
- EXISTING SEWER
- NEW SEWER
- EXISTING STORMWATER
- NEW STORMWATER
- EXISTING GAS
- NEW GAS
- EXISTING POWER
- NEW POWER
- EXISTING TELEPHONE
- NEW TELEPHONE
- EXISTING FIBRE OPTIC
- NEW FIBRE OPTIC
- EXISTING DRAIN
- NEW DRAIN
- EXISTING ROADSIDE DRAIN
- NEW ROADSIDE DRAIN
- EXISTING EXHAUST
- NEW EXHAUST
- EXISTING MECHANICAL SERVICES
- NEW MECHANICAL SERVICES
- EXISTING ELECTRICAL SERVICES
- NEW ELECTRICAL SERVICES
- EXISTING TELEPHONE SERVICES
- NEW TELEPHONE SERVICES
- EXISTING FIBRE OPTIC SERVICES
- NEW FIBRE OPTIC SERVICES
- EXISTING DRAIN SERVICES
- NEW DRAIN SERVICES
- EXISTING ROADSIDE DRAIN SERVICES
- NEW ROADSIDE DRAIN SERVICES
- EXISTING EXHAUST SERVICES
- NEW EXHAUST SERVICES
- EXISTING MECHANICAL SERVICES
- NEW MECHANICAL SERVICES
- EXISTING ELECTRICAL SERVICES
- NEW ELECTRICAL SERVICES
- EXISTING TELEPHONE SERVICES
- NEW TELEPHONE SERVICES
- EXISTING FIBRE OPTIC SERVICES
- NEW FIBRE OPTIC SERVICES
- EXISTING DRAIN SERVICES
- NEW DRAIN SERVICES
- EXISTING ROADSIDE DRAIN SERVICES
- NEW ROADSIDE DRAIN SERVICES
- EXISTING EXHAUST SERVICES
- NEW EXHAUST SERVICES
- EXISTING MECHANICAL SERVICES
- NEW MECHANICAL SERVICES
- EXISTING ELECTRICAL SERVICES
- NEW ELECTRICAL SERVICES
- EXISTING TELEPHONE SERVICES
- NEW TELEPHONE SERVICES
- EXISTING FIBRE OPTIC SERVICES
- NEW FIBRE OPTIC SERVICES

X:\2562\15R2\15R2-151-152-153-154-155-156-157-158-159-160-161-162-163-164-165-166-167-168-169-170-171-172-173-174-175-176-177-178-179-180-181-182-183-184-185-186-187-188-189-190-191-192-193-194-195-196-197-198-199-200-201-202-203-204-205-206-207-208-209-210-211-212-213-214-215-216-217-218-219-220-221-222-223-224-225-226-227-228-229-230-231-232-233-234-235-236-237-238-239-240-241-242-243-244-245-246-247-248-249-250-251-252-253-254-255-256-257-258-259-260-261-262-263-264-265-266-267-268-269-270-271-272-273-274-275-276-277-278-279-280-281-282-283-284-285-286-287-288-289-290-291-292-293-294-295-296-297-298-299-300-301-302-303-304-305-306-307-308-309-310-311-312-313-314-315-316-317-318-319-320-321-322-323-324-325-326-327-328-329-330-331-332-333-334-335-336-337-338-339-340-341-342-343-344-345-346-347-348-349-350-351-352-353-354-355-356-357-358-359-360-361-362-363-364-365-366-367-368-369-370-371-372-373-374-375-376-377-378-379-380-381-382-383-384-385-386-387-388-389-390-391-392-393-394-395-396-397-398-399-400-401-402-403-404-405-406-407-408-409-410-411-412-413-414-415-416-417-418-419-420-421-422-423-424-425-426-427-428-429-430-431-432-433-434-435-436-437-438-439-440-441-442-443-444-445-446-447-448-449-450-451-452-453-454-455-456-457-458-459-460-461-462-463-464-465-466-467-468-469-470-471-472-473-474-475-476-477-478-479-480-481-482-483-484-485-486-487-488-489-490-491-492-493-494-495-496-497-498-499-500-501-502-503-504-505-506-507-508-509-510-511-512-513-514-515-516-517-518-519-520-521-522-523-524-525-526-527-528-529-530-531-532-533-534-535-536-537-538-539-540-541-542-543-544-545-546-547-548-549-550-551-552-553-554-555-556-557-558-559-560-561-562-563-564-565-566-567-568-569-570-571-572-573-574-575-576-577-578-579-580-581-582-583-584-585-586-587-588-589-590-591-592-593-594-595-596-597-598-599-600-601-602-603-604-605-606-607-608-609-610-611-612-613-614-615-616-617-618-619-620-621-622-623-624-625-626-627-628-629-630-631-632-633-634-635-636-637-638-639-640-641-642-643-644-645-646-647-648-649-650-651-652-653-654-655-656-657-658-659-660-661-662-663-664-665-666-667-668-669-670-671-672-673-674-675-676-677-678-679-680-681-682-683-684-685-686-687-688-689-690-691-692-693-694-695-696-697-698-699-700-701-702-703-704-705-706-707-708-709-710-711-712-713-714-715-716-717-718-719-720-721-722-723-724-725-726-727-728-729-730-731-732-733-734-735-736-737-738-739-740-741-742-743-744-745-746-747-748-749-750-751-752-753-754-755-756-757-758-759-760-761-762-763-764-765-766-767-768-769-770-771-772-773-774-775-776-777-778-779-780-781-782-783-784-785-786-787-788-789-790-791-792-793-794-795-796-797-798-799-800-801-802-803-804-805-806-807-808-809-810-811-812-813-814-815-816-817-818-819-820-821-822-823-824-825-826-827-828-829-830-831-832-833-834-835-836-837-838-839-840-841-842-843-844-845-846-847-848-849-850-851-852-853-854-855-856-857-858-859-860-861-862-863-864-865-866-867-868-869-870-871-872-873-874-875-876-877-878-879-880-881-882-883-884-885-886-887-888-889-890-891-892-893-894-895-896-897-898-899-900-901-902-903-904-905-906-907-908-909-910-911-912-913-914-915-916-917-918-919-920-921-922-923-924-925-926-927-928-929-930-931-932-933-934-935-936-937-938-939-940-941-942-943-944-945-946-947-948-949-950-951-952-953-954-955-956-957-958-959-960-961-962-963-964-965-966-967-968-969-970-971-972-973-974-975-976-977-978-979-980-981-982-983-984-985-986-987-988-989-990-991-992-993-994-995-996-997-998-999-1000