

VERSION	REVISIONS	DATE	BY	DESCRIPTION
A	PRELIMINARY ISSUE	07/05/19	JC	
B	CONCUL COMMENT (23/05/19)	19/06/19	JC	
C	CONCUL COMMENT (02/07/19)	04/07/19	JC	
D	CITY WEST WATER ISSUE	08/08/19	JC	
E	ADDED FOOTPATH & VEHICLE CROSSINGS ON ALCOCK ROAD	03/09/19	JC	

THIS DRAWING IS NOT TO BE CROPPED OR SCALED
FOR CONTINUATION REFER TOP RIGHT

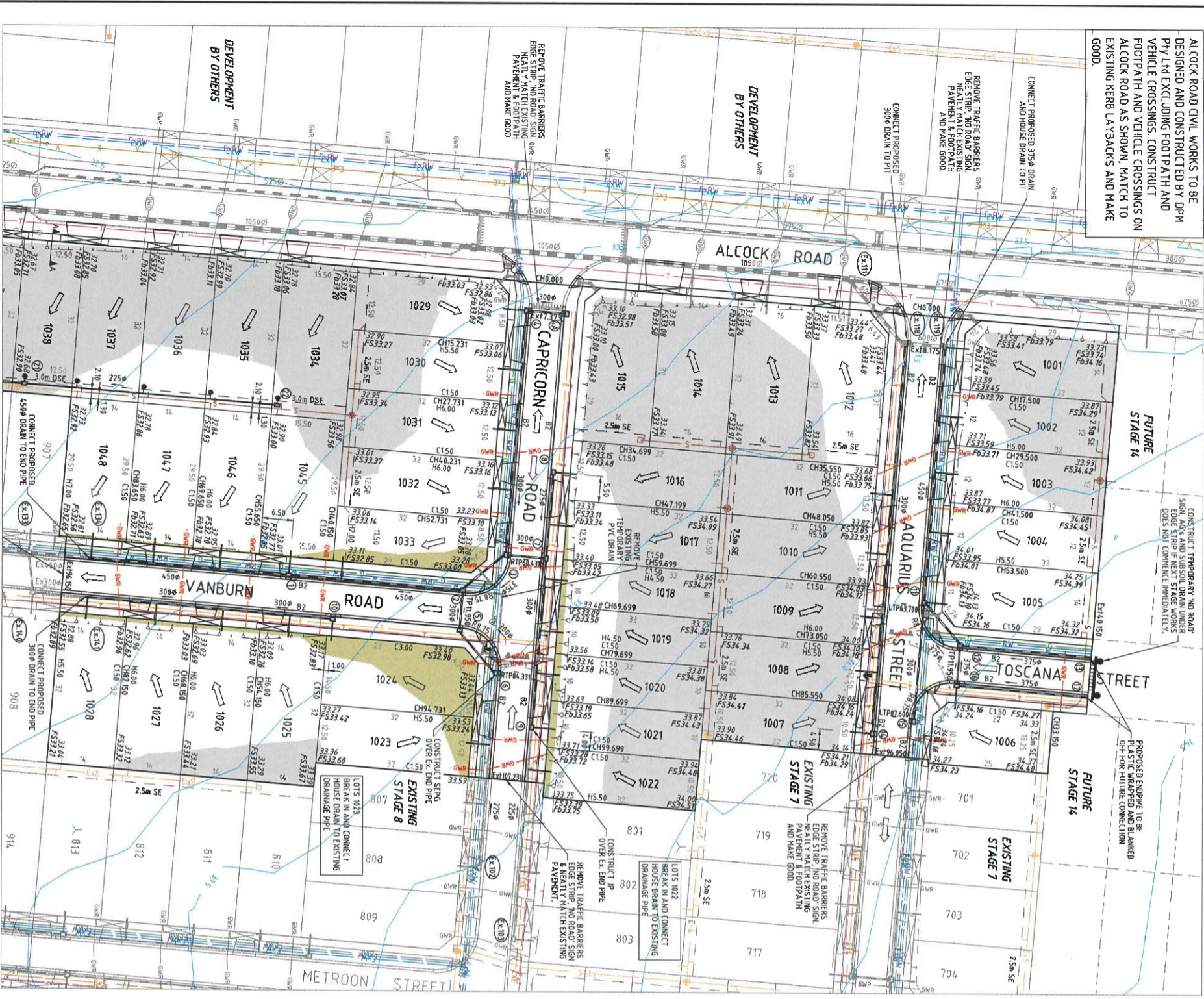

DESIGNED BY	JCHIN
CHECKED BY	LPHAN
APPROVED BY	S.SIBALVAS
DRAWN BY	KKASIA
DATE	203_C2

FOR CONTINUATION, REFER BOTTOM LEFT

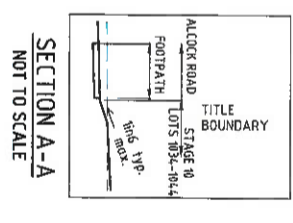
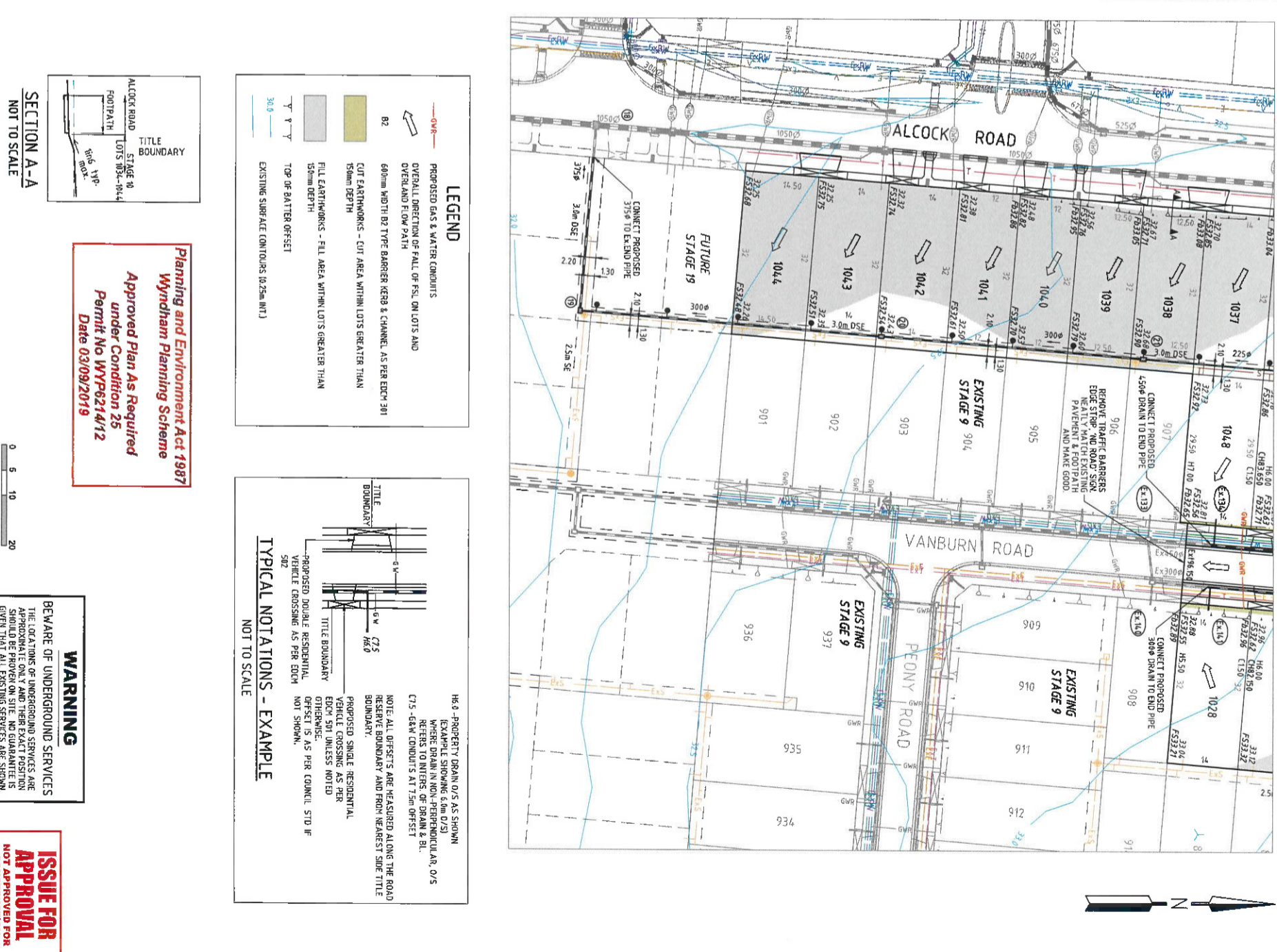

Planting and Environment Act 1987
Wyndham Planning Scheme
Approved Plan As Required
under Condition 25
Permit No WYP6214/12
Date 03/09/2019



WARNING
BEWARE OF UNDERGROUND SERVICES
THE LOCATIONS OF UNDERGROUND SERVICES ARE APPROXIMATE ONLY AND THEIR EXACT POSITION SHOULD BE PROVIDED ON SITE. NO GUARANTEE IS GIVEN THAT ALL EXISTING SERVICES ARE SHOWN.

- LEGEND**
- PROPOSED GAS & WATER CONDUITS
 - OVERALL DIRECTION OF FLOW OF FSL ON LOTS AND OVERLAND FLOW PATH
 - 600mm WIDTH B2 TYPE BARRIER KERB & CHANNEL, AS PER EDCM 301
 - CUT FASTENERS - CUT AREA WITHIN LOTS GREATER THAN 150mm DEPTH
 - FILL FASTENERS - FILL AREA WITHIN LOTS GREATER THAN 150mm DEPTH
 - TOP OF BATTER OFFSET
 - EXISTING SURFACE CONTOURS (0.25m INT)

- LEGEND**
- PROPOSED GAS & WATER CONDUITS
 - OVERALL DIRECTION OF FLOW OF FSL ON LOTS AND OVERLAND FLOW PATH
 - 600mm WIDTH B2 TYPE BARRIER KERB & CHANNEL, AS PER EDCM 301
 - CUT FASTENERS - CUT AREA WITHIN LOTS GREATER THAN 150mm DEPTH
 - FILL FASTENERS - FILL AREA WITHIN LOTS GREATER THAN 150mm DEPTH
 - TOP OF BATTER OFFSET
 - EXISTING SURFACE CONTOURS (0.25m INT)

- TYPICAL NOTATIONS - EXAMPLE**
NOT TO SCALE
- H.R. - PROPERTY DRAIN O/S AS SHOWN (EXAMPLE SHOWING 6.0m D/S) WHERE DRAIN IS NON-PERPENDICULAR O/S REFERS TO INTERS OF DRAIN & B.L.
 - C.T.S. - G.W. CONDUITS AT 75m OFFSET
 - NOTE: ALL OFFSETS ARE MEASURED ALONG THE ROAD RESERVE BOUNDARY AND FROM NEAREST SIDE TITLE BOUNDARY.
 - PROPOSED SINGLE RESIDENTIAL VEHICLE CROSSING AS PER EDCM 501 UNLESS NOTED OTHERWISE.
 - OFFSET IS AS PER CONCUL STD IF NOT SHOWN.

ISSUE FOR APPROVAL
NOT APPROVED FOR CONSTRUCTION

REEDS CONSULTING
LAND SURVEYING
CIVIL ENGINEERING
PLANNING
DEVELOPMENT CONSULTING

1/44, 422 Elizabeth Street, Melbourne, Victoria 3000
P 03 9494 3000
www.reedsconsulting.com.au
enquiries@reedsconsulting.com.au

WYNDHAM CITY COUNCIL
80 WOODS ROAD, TRUGANINA
STAGE 10
LAYOUT PLAN

DRAWING No. 10R2
VERSION E
REFERENCE 22562E/10
SHEET 2 OF 14